

## Automatic Transfer Switches

## GenReady™ Series Load Centers and Transfer Switch



Model: G005449-2



Model: G005454-2

Models: G005447-0  
G005449-2  
G005454-2



\*Assembled in the USA using domestic and foreign parts

### GenReady Load Center Description

The GenReady load center is a hybrid panel that operates as a normal load center and also allows for seamless integration of standby generators. It is available in a NEMA 1 configuration for indoor installations, or in a NEMA 3R configuration for outdoor applications. For installation flexibility, it is multi-listed for use with multiple breaker manufacturers

### GenReady Load Center Standard Features

- 200 amp
- 40 circuit capacity with the use of tandem breakers
- Dimensions are the same as a standard 42-space main load center
- Utilizes standard Siemens components
- Protect up to 18 circuits, up to 30 with the use of tandem breakers
- 10 circuits available for non-protected loads
- Circuits can easily be shifted from protected to non-protected and vice versa
- ETL listed for service equipment and consumer safety
- Single panels are compatible with generators rated up to 125 Amps/30 kW
- Multiple GenReady load centers can be supported with a single generator
- Flush Mount NEMA 1 Enclosure or NEMA 3R Enclosure
- 5 Year Limited Warranty

**GenReady Load Center and Transfer Switch**

**GenReady Load Center Product Options**

NEMA 1 GenReady Advanced Load Center with EZ Transfer Operator Model: G005449-2	NEMA 3R GenReady Advanced Load Center with EZ Transfer Operator Model: G005454-2
EZ Transfer Operator	EZ Transfer Operator
125A Lower Panel, Generator Circuit Switch	125A Lower Panel, Generator Circuit Switch
15A Double Pole Breaker for Sensing Circuit	15A Double Pole Breaker for Sensing Circuit
Plus all other components found in the field installation kit.	Plus all other components found in the field installation kit.

**EZ Transfer Operator Field Installation Kit, Model: G005447-0**

- Factory installed on the GenReady Advanced models (G005449-2, G005454-2). Can be easily installed in the field on the GenReady Basic models (G005448-2, G005453-2) with available kit
- Allows for manual or automatic operation
- Transfer Operator
- 15A Double Pole Breaker for Generator Sensing Circuit
- 125A Lower Panel, Generator Circuit Switch
- Hold Down Bracket
- Interlock Bar
- Mounting Hardware
- Decals
- Installation Guide

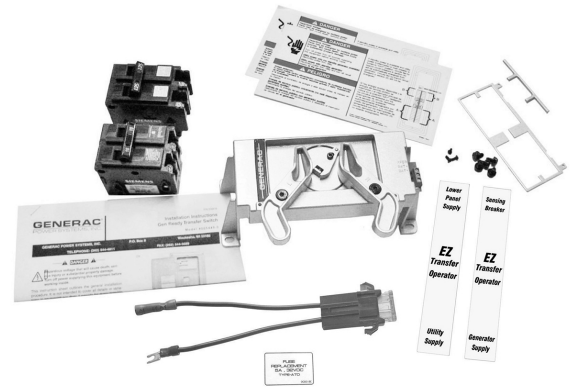

**Specifications**

<b>Enclosure</b>	NEMA Type 1, or NEMA 3R, galvanized G90 steel w/ polyester powder coat
<b>Main Breaker</b>	200 Amp
<b>Generator Switch</b>	125 Amp
<b>Main Breaker Wire Size</b>	# 1 to 300 mcm Cu-Al
<b>Generator Switch Wire Size</b>	# 2 to 1/0 Cu, 1/0-2/0 Al
<b>Neutral Lug</b>	# 6 to 300 mcm
<b>Ground Lug</b>	# 14- 2/0
<b>Withstanding Rating Main Bus (amps)</b>	10,000
<b>Meets NEC Wire Bending Space</b>	Yes
<b>ETL Listed</b>	Yes
<b>Seismically Qualified to Meet UBC Code</b>	Yes
<b>Weight (lbs/kg)</b>	49/22.2
<b>Operating Temperature Range</b>	-20 °F to 140 °F / -29 °C to 60 °C
<b>Maximum Number of Circuits (standard 1" breakers / tandem breakers)</b>	
Protected circuits	18/30
Non-protected circuits	10/NA
<b>Total circuits</b>	<b>28/40</b>

**Installation Options**

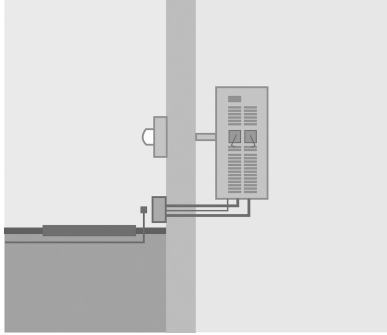
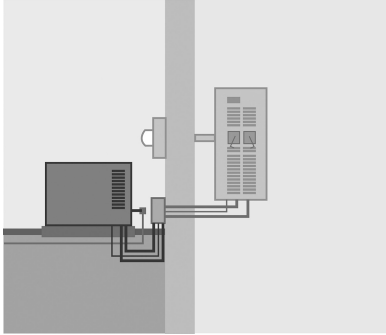
GenReady Advanced	GenReady Complete
	
<p>The GenReady load center is installed with the EZ Transfer Operator. All fuel and electrical lines (contractor supplied) are installed to the planned generator site along with the generator pad (if required). The home is completely wired and ready for the addition of a generator in the future.</p>	<p>Everything included in the GenReady Advanced level is installed along with an automatic standby generator. The home's selected circuits will be backed up by generator power whenever the utility is lost.</p>
<p>The NEMA 3R GenReady installation is similar but is suitable for outdoor installations.</p>	

**Dimensions**

Model		G005449-2 (Door)	G005449-2 (Body)	G005454-2
Height (in/cm)	H1	43.3 / 110	42 / 107	42 / 107
Width (in/cm))	W1	15.6 / 39.6	14.4 / 36.6	14.4 / 36.6
	W2	-	-	14.9 / 37.8
Depth (in/cm)	D1	-	4 / 10.2	4.5 / 11.3
	D2	-	-	5 / 12.7

